

Schedule 5 - Attachment 1 – Survey Plan

Invitation Name: 88 Mudlo Road, Kilkivan – Community Facilities Management Agreement
Invitation Number: RF1009



Invitation Name:

88 Mudlo Road, Kilkivan - Community Facilities Management Agreement

Invitation Number:

RFI009

LX478 V0 Page 1 of 1 Not To Scale

Reference to Traverse and Road Sections.

Line	Bearing	Dist.
1-5	107°15'	830.4
6	152°	745.7
7	101°22'	782.2

Particulars

No.	Date of Birth	Form No.	Selectors	Bound & marked	Remarks
91				20 3. 8	not set.

Date of Instructions 24. 11. 10
 Date of transmission of plans &c. 17. 12. 10
 Examined by J.M. 21/1/11 Charted by J.M. 23/3/11
 Voucher No. Passed for payment
 Sales Register Vol. 10 Fol. 173
 Scale 10 Chains to an Inch.

Reference to Corners.

Corner	Bearing	From	Dist.	Mark
Page 87.				
3	82°10'	16K.	17.	87
4	265°45'	"	24.2	"
5	281°30'	Ah.	15.	249
				87.
Page 91				
3	288°51'	Gum	571	81
4	317°	Apple	75.	81
5	245°50'	16K.	28.	101
10	7°50'	Ash	115.	81
11	238°21'	Gum	88.2	81
12	27°22'	"	577	81

For Alluvial Plans & Documents Holdings Refer to 5294

SURVEY OFFICE
 23770/3 19001810
 QUEENSLAND.

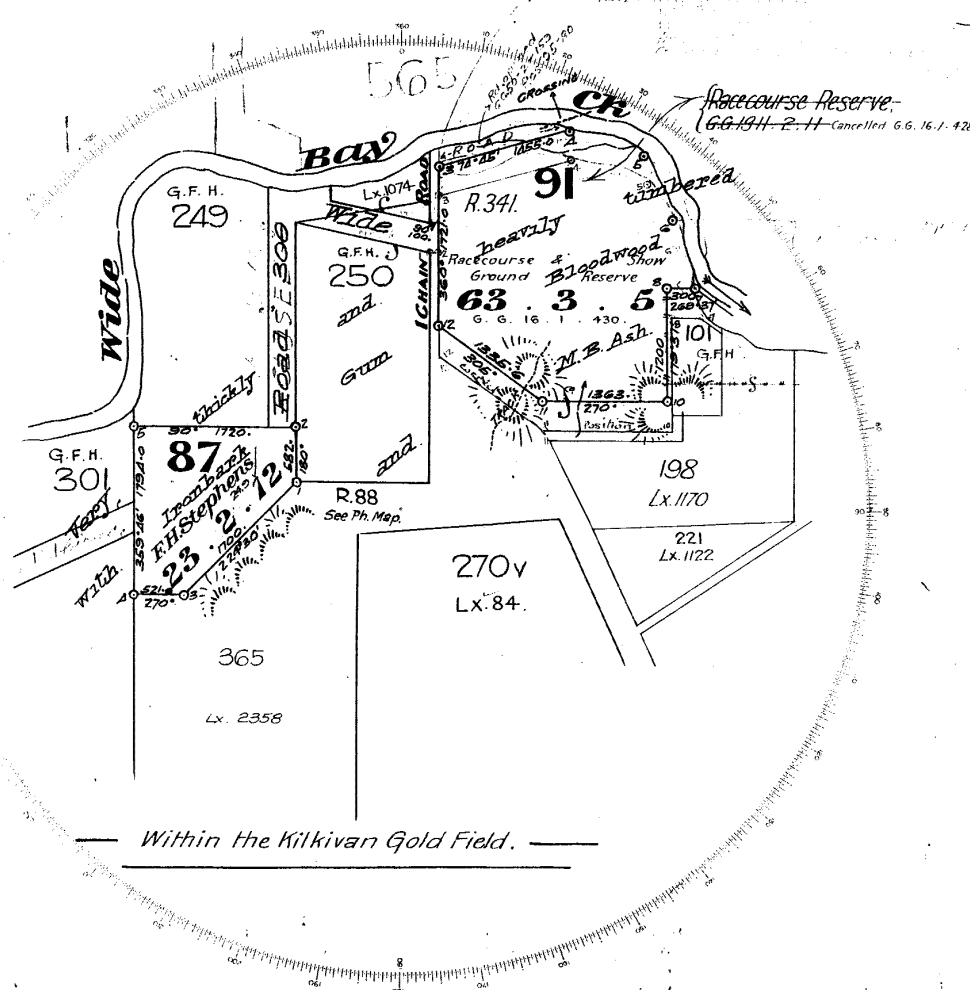

Within the Kilkivan Gold Field.

(Kilkivan Shire.)

I hereby certify that I, in person, made, and on the 190 completed the survey represented by this plan, on which are written the bearings and lengths of the lines surveyed by me, and that the survey has been executed in accordance with the existing regulations of the Surveyor-General's Department.

John Devereux
 Surveyor
 23/12/10

To U.S. 12.4.11
 23

Meridian Observations

No.	Date	Lat.	Long.	Baromet.	Baromet. Reduct.	Time	M. Cor. Sun.	Observed Altitude	Reduced Altitude	Bearing

NOTE: Observing stations are shown by triangles in red.

Photo'd.
 18. 2. 11 G.R.

PLAN OF
 PORTION N^o 87 and 91
 PARISH OF KILKIVAN
 County of LENNOX
 Land Agents Gympie
 District of
 Cat. LX.478.

LX478