

# Schedule 5 - Attachment 1 – Survey Plan

**Invitation Name:** Cooloola Coast Community Complex – Lease Area F – Vacant Land Trustee Lease Agreement

**Invitation Number:** IFT014



910971

PLAN MUST BE DRAWN WITHIN BLACK LINES

910971

910971

WARNING - PLAN MAY BE ROLLED - A FOLDED OR MUTILATED PLAN WILL NOT BE ACCEPTED

910971

REFERENCE MARKS				
STN	TO	ORIGIN	BEARING	DIST
2	Pin		113°0'	17.689
3	OIP	9/MCH814915	56°28'	0.94
4	Pin		34°07'	4.77
5	Pin		65°17'	4.47
6	Pin		71°45'	1.247
7	Pin		58°23'	1.284
8	OIP	16/MCH814915	102°50'	1.22

PERMANENT MARKS				
PM	ORIGIN	BEARING	DIST	NO
1a-OPM	4a/MCH814915	a1	stn	102204

TRAVERSES ETC		
LINE	BEARING	DISTANCE
1-1a	25°09'30"	447.787

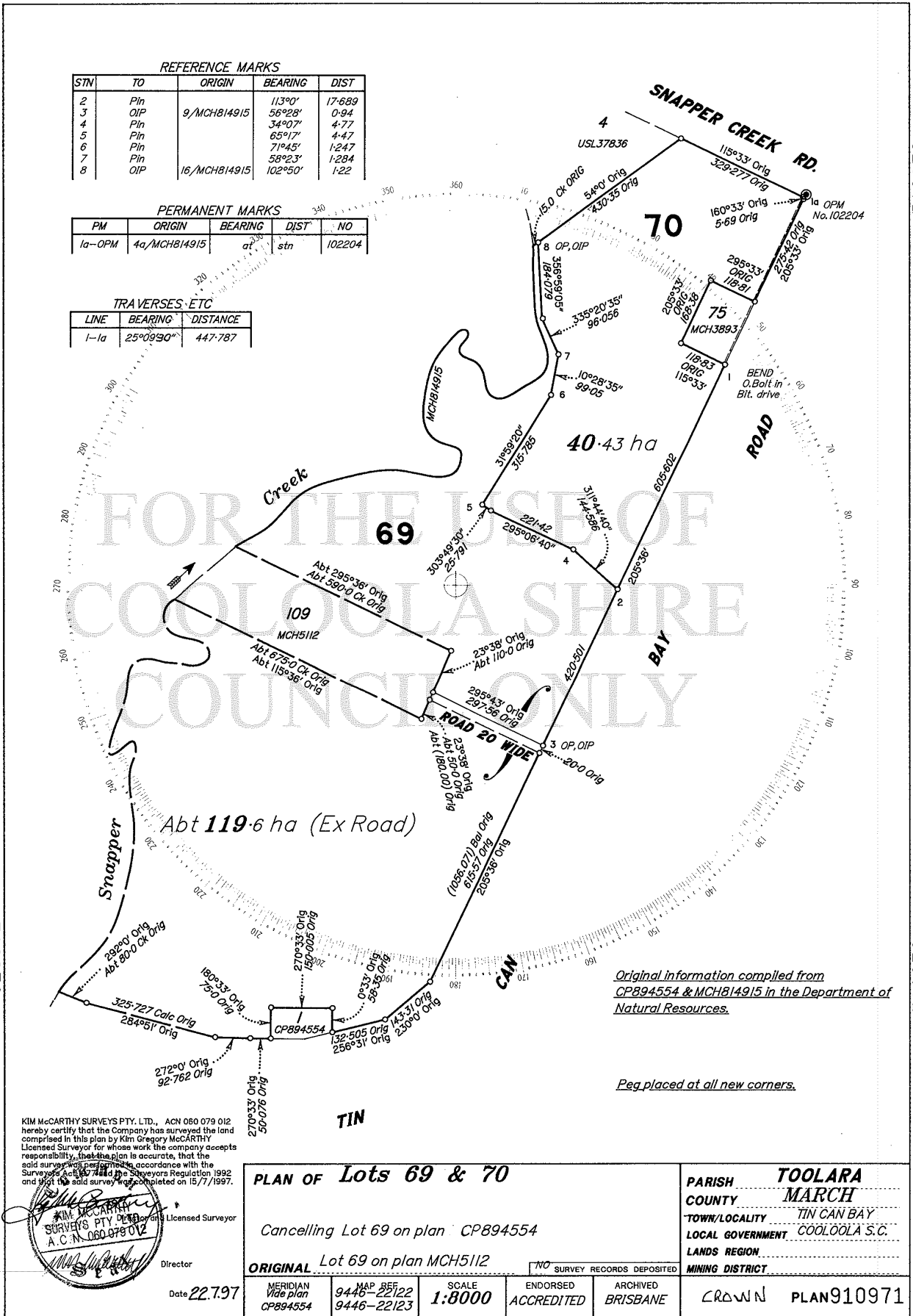

Original information compiled from CP894554 & MCH814915 in the Department of Natural Resources.

Peg placed at all new corners.

KIM MCCARTHY SURVEYS PTY. LTD., ACN 060 079 012 hereby certify that the Company has surveyed the land comprised in this plan by Kim Gregory MCCARTHY Licensed Surveyor for whose work the company accepts responsibility, that the plan is accurate, that the said survey was performed in accordance with the Surveyors Act 1992 and the Surveyors Regulation 1992 and that the said survey was completed on 15/7/1997.

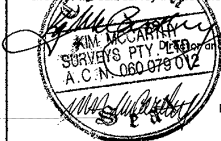

Director

Date 22.7.97

<b>PLAN OF Lots 69 &amp; 70</b> Cancelling Lot 69 on plan CP894554 ORIGINAL Lot 69 on plan MCH5112		PARISH <b>TOOLARA</b> COUNTY <b>MARCH</b> TOWN/LOCALITY <b>TIN CAN BAY</b> LOCAL GOVERNMENT <b>COOLLOOLA S.C.</b> LANDS REGION MINING DISTRICT	
MERIDIAN Vide plan CP894554	MAP REF 9446-22122 9446-22123	SCALE <b>1:8000</b>	ENDORSED ACCREDITED
NO SURVEY RECORDS DEPOSITED		ARCHIVED BRISBANE	CROWN PLAN 910971

